



青岛三德啤酒设备有限公司

QINGDAO SANDERUILE
BEER EQUIPMENT CO.,LTD



青岛市城阳区夏庄街道丹山工业园景安路与仙山东路交叉口北段
JINGAN ROAD, CHENGYANG DISTRICT, QINGDAO266107



0532-67731107



info@sandebeer.com
info1@sandebeer.com
info2@sandebeer.com
info3@sandebeer.com



www.sandebeer.com

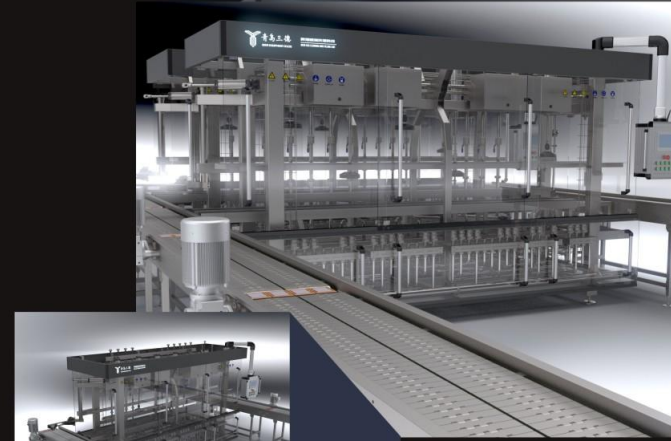

QINGDAO
SANDERUILE
BEER
EQUIPMENT CO.,LTD

青岛三德啤酒设备有限公司

www.sandebeer.com

公司简介

COMPANY PROFILE

青岛三德啤酒设备有限公司，创建于2014年，公司拥有从事该行业二十多年的核心团队，专业生产扎啤机、啤酒桶清洗机，啤酒桶灌装机，易拉罐灌装机，瞬时杀菌机和啤酒桶清洗灌装线等。拥有经验丰富、技术创新的专业研发团队和高度专注、精益求精的生产制造车间。

本公司坐落于富有“世界啤酒之城”盛誉的海滨城市——青岛，国际性的海港以及区域性枢纽空港，使本公司占有得天独厚的国际贸易往来优势。自成立以来，公司通过引进新的技术使得产品多元化，并且得到众多中外业内人士的拥戴。

本公司生产的易拉罐灌装机、售酒设备、桶装清洗灌装设备、杀菌机等设备，与全球多家知名企业形成战略合作伙伴关系。现如今，公司产品在全球热销，成为该行业领军品牌之一。

我们坚持以质量第一，技术可靠为宗旨，信守于胸，惠至于人为理念，与时俱进，共同发展。

Qingdao Sanderuile Beer Equipment Co., LTD., founded in 2014, has a core team engaged in the industry for more than 20 years, specializing in the production of beer kegerator, beer keg washing machine, beer keg filling machine, canning system, pasteurizer and beer keg washing and filling line. Has experienced, technical innovation of professional R & D team, and highly focused, excelsior manufacturing workshop.

Our company is located in Qingdao, the famous coastal city of "world beer City", the international seaport and regional hub airport, so that our company has a unique advantage in international trade. Since its establishment, the company through the introduction of new technology, so that the product diversification, and many domestic and foreign industry people support.

The company produces canning system, kegerator, keg washer and filler, pasteurizer and other equipment sold to the world, and a number of well-known enterprises in the world to form a strategic partnership. Today, the company's products sell well around the world and become one of the leading brands in the industry.

We adhere to the quality first, reliable technology for the purpose, abides by the chest, as for the concept of human benefit, advancing with The Times, common development.

BEER KEG WASHER

清洗机

产品特点

- 操作简单，技术成熟，清洗稳定可靠
- 根据客户需求选配工位水箱水泵及加热方式
- 中英文界面，PLC采用德国西门子品牌，精准控制
- 设备整体采用SUS304，管路焊接采用德国自动管路焊接设备，一次性焊接双面成型
- 提供订制服务，可根据客户要求订制清洗工艺

Product features

- Simple operation, mature technology, stable and reliable cleaning
- According to customer demand, the station water tank, water pump and heating mode are optional
- English and Chinese interface, PLC adopts German Siemens brand, precise control
- SUS304 is adopted as the whole equipment, and German automatic pipe welding equipment is used for pipe welding
- To provide customized services, according to customer requirements customized cleaning process



Semi-auto keg washer 手动清洗机

设备名称 (Name)	单工位手动清洗机 Semi-auto Single station keg washer	双工位手动清洗机 Semi-auto double station keg washer	双工位手动清洗机 Semi-auto double station keg washer
设备型号 (Model)	CM1-22S(E)-N-S-3	CM2-22S(E)-N-S-3	CM2-33E(S)-N-S-3
设备尺寸 (Size:W*L*H)	1.47X1.67X1.50M	1.54X1.36X1.40M	1.6X1.42X1.44M
设备重量 (Weight)	180KG	187KG	240KG
外包装尺寸 Packing Size (L*W*H)	1.32X1.52X1.57M	1.69X1.51X1.60M	1.61X1.81X1.65M
包装重量 (Gross Weight)	327KG	332KG	395KG
工作能力 (Capacity)	15-20pcs/h	30-40pcs/h	30-40pcs/h
电源参数 (Power)	According to user local power	According to user local power	According to user local power
加热类型 (Heater way)	Steam coiler or Electrical Heater	Steam coiler or Electrical Heater	Steam coiler or Electrical Heater
水箱材质与容积 (Water tank material and volume)	SUS304单水箱/容量 Single tank / Volume=100L (2pcs)	SUS304单水箱/容量 Single tank / Volume=100L(2pcs)	SUS304 单水箱/容量 Single tank / Volume=100L(3pcs)



Auto keg washer 自动清洗机

设备名称 (Name)	单工位啤酒桶清洗机 Single station keg washer	单工位啤酒桶清洗机 Single station keg washer	单工位啤酒桶清洗机 Single station keg washer
设备型号 (Model)	CA1-11S(E)-T-S-2	CA1-22S(E)-T-H-1	CA1-33S(E)-T-H-1
设备尺寸 (Size:W*L*H)	1.20X1.05X2.03M	1.20X1.05X2.03M	1.40X1.60X2.04M
设备重量 (Weight)	238KG	238KG	264KG
外包装尺寸 Packing Size (L*W*H)	1.35X1.16X2.25M	1.35X1.16X2.25M	1.50X1.75X2.28M
包装重量 (Gross Weight)	369KG	369KG	414KG
工作能力 (Capacity)	20-30pcs/h	20-30pcs/h	50-60pcs/h
电源参数 (Power)	According to user local power	According to user local power	According to user local power
加热类型 (Heater way)	Steam coiler or Electrical Heater	Steam coiler	Steam coiler or Electrical Heater
水箱材质与容积 (Water tank material and volume)	SUS304 单水箱/容量 Single tank / Volume=100L(1pc)	SUS304单水箱/容量 Single tank / Volume=100L(2pcs)	SUS304单水箱/容量 Single tank / Volume=100L(3pcs)



Auto keg washer 自动清洗机

设备名称 (Name)	双工位啤酒桶清洗机 Double stations keg washer	双工位啤酒桶清洗机 Double stations keg washer
设备型号 (Model)	CA2-22S(E)-T-H-1	CA2-33S(E)-T-H-1
设备尺寸 (Size:W*L*H)	1.20X1.51X2.05M	1.40X1.60X2.03M
设备重量 (Weight)	240KG	290KG
外包装尺寸 Packing Size (L*W*H)	1.65X1.41X2.28M	1.55X1.75X2.25M
包装重量 (Gross Weight)	400KG	420KG
工作能力 (Capacity)	40-60pcs/h	40-60pcs/h
电源参数 (Power)	According to user local power	According to user local power
加热类型 (Heater way)	Steam coiler or Electrical Heater	Steam coiler or Electrical Heater
水箱材质与容积 (Water tank material and volume)	SUS304单水箱/容量 Single tank / Volume=100L(2pcs)	SUS304单水箱/容量 Single tank / Volume=100L(3pcs)

设备名称 (Name)	双工位啤酒桶清洗机 Double stations keg washer	双工位啤酒桶清洗机 Double stations keg washer	三工位啤酒桶清洗机 Three stations keg washer
设备型号 (Model)	CA2-22E-T-S-2	CA2-22E-T-S-3	CA3-33E(S)-T-S-2
设备尺寸 (Size:W*L*H)	1.10X1.30X1.67M	1.10X1.30X1.67M	1.83X1.20X1.67M
设备重量 (Weight)	211KG	211KG	306KG
外包装尺寸 Packing Size (L*W*H)	1.50X1.31X1.45M	1.50X1.31X1.45M	1.98X1.40X1.45M
包装重量 (Gross Weight)	329KG	329KG	455KG
工作能力 (Capacity)	30-40pcs/h	30-40pcs/h	45-60pcs/h
电源参数 (Power)	According to user local power	According to user local power	According to user local power
加热类型 (Heater way)	Electrical Heater	Electrical Heater	Steam coiler or Electrical Heater
水箱材质与容积 (Water tank material and volume)	SUS304单水箱/容量 Single tank / Volume=100L(2pcs)	SUS304单水箱/容量 Single tank / Volume=100L(2pcs)	SUS304单水箱/容量 Single tank / Volume=100L(3pcs)





设备名称 (Name)	四工位啤酒桶清洗机 Four stations keg washer	四工位啤酒桶清洗机 Four stations keg washer
设备型号 (Model)	CA4-22S(E)-T-H-1	CA4-33S(E)-T-H-1
设备尺寸 (Size:W*L*H)	3.20X1.70X2.10M	3.20X1.70X2.10M
设备重量 (Weight)	400KG	450KG
外包装尺寸 Packing Size (L*W*H)	3.41X1.90X2.35M	3.41X1.90X2.35M
包装重量 (Gross Weight)	650KG	700KG
工作能力 (Capacity)	60-120pcs/h	60-120pcs/h
电源参数 (Power)	According to user local power	According to user local power
加热类型 (Heater way)	Steam coiler or Electrical Heater	Steam coiler or Electrical Heater
水箱材质与容积 (Water tank material and volume)	SUS304 单水箱/容量 Single tank / Volume=100L(2pcs)	SUS304 单水箱/容量 Single tank / Volume=100L(3pcs)

OEM 定制

可承接OEM加工生产，资质齐全，种类多样，技术可靠，品质一流，一站式服务。专业为精酿啤酒设备厂商，贸易商和精酿啤酒设备使用者打造自有品牌。把繁琐的品牌研发生产放心交给三德。

Can undertake OEM processing and production, complete qualification, variety, reliable technology, first-class quality, one-stop service. Specializing in the creation of private brands for craft beer equipment manufacturers, traders and users of craft beer equipment. The tedious brand research and development production trust to Sande.



FILLING MACHINE

灌装机

产品特点

- 多种规格选配，可供根据客户需求选择
- 西门子控制单元，精准控制
- 材质为精选食品级304不锈钢，经久耐用，质量可靠
- 可灌装多种桶形规格，独立控制，灵活方便

Product features

- Various specifications are optional, available according to customer needs
- Siemens control unit, precise control
- Material for selected food grade 304 stainless steel, durable, reliable quality
- Can fill a variety of keg specifications, independent control, flexible and convenient



Filling Machine 灌装机



设备名称 (Name)	单工位灌装机 (不含流量计) Single head keg filler without flowmeter	单工位灌装机 (含流量计) Single head keg filler with flowmeter
设备型号 (Model)	F1-N-N	F1-T-M
设备尺寸 (Size:W*L*H)	0.60X0.65X1.57M	0.60X0.65X1.57M
设备重量 (Weight)	68KG	70KG
工作能力 (Capacity)	50-60pcs/h(30L) 30-40pcs/h(50L)	50-60pcs/h(30L) 30-40pcs/h(50L)
电源参数 (Power)	Singel Phase 110V-240V 50/60Hz is default	Singel Phase 110V-240V 50/60Hz is default
适用桶形 Keg type	欧标 德标 美标 EURO DIN AMERICAN 20L-60Lkeg	欧标 德标 美标 EURO DIN AMERICAN 20L-60Lkeg

设备名称 (Name)	双工位灌装机 (不含流量计) Double heads keg filler without flowmeter	双工位灌装机 (含流量计) Double heads keg filler with flowmeter
设备型号 (Model)	F2-N-N	F2-T-M
设备尺寸 (Size:W*L*H)	0.60X0.96X1.57M	0.60X0.96X1.57M
设备重量 (Weight)	100KG	102KG
工作能力 (Capacity)	100-120pcs/h(30L) 60-80pcs/h(50L)	100-120pcs/h(30L) 60-80pcs/h(50L)
电源参数 (Power)	Singel Phase 110V-240V 50/60Hz is default	Singel Phase 110V-240V 50/60Hz is default
适用桶形 Keg type	欧标 德标 美标 EURO DIN AMERICAN 20L-60Lkeg	欧标 德标 美标 EURO DIN AMERICAN 20L-60Lkeg



Pet Keg Filler PET桶灌装机

设备名称 (Name)	PET双工位灌装机 PET double station filling machine
设备型号 (Model)	PETAF-75
设备尺寸 (Size:W*L*H)	0.96X1.00X1.85M
设备重量 (Weight)	290KG
工作能力 (Capacity)	20L-70pcs/h 30L-60pcs/h
电源参数 (Power)	3P AC380V 50Hz is default
适用桶形 Keg type	PET桶/钢桶; 直径230-322; 高度532-600



产品特点

- 最新研发产品，适用于多种桶类。
- 采用德国进口流量计对灌装量进行精确控制
- 控制单元采用德国西门子，进行全过程自动控制，参数通过触摸屏调整，显示工作流程
- 双工位灌装，独立控制，灵活高效

Product features

- Newly developed products, suitable for a variety of kegs
- Imported flowmeter from Germany is used to accurately control the filling volume
- The control unit is made by Siemens, and the whole process is automatically controlled. The parameters are adjusted by touch screen to display the work flow
- Double station filling, independent control, flexible and efficient

Tin Can Filler 马口铁灌装机

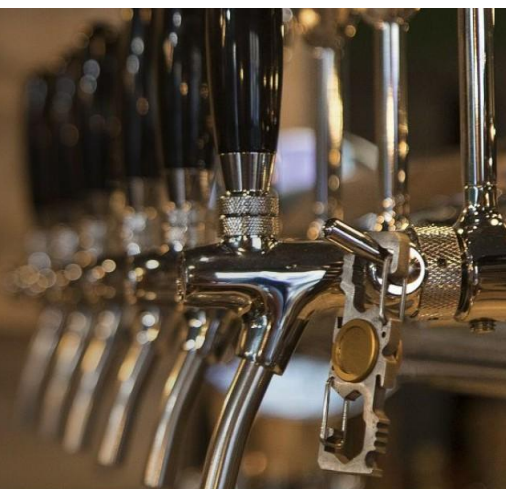

产品特点

- 马口铁1L-5L桶专用
- 材质为精选食品级304不锈钢，经久耐用，质量可靠
- 西门子控制单元，精准控制

Product features

- Material for selected food grade 304 stainless steel, durable, reliable quality
- Siemens control unit, precise control.

设备名称 (Name)	马口铁桶灌装机 Smei-automatic Beer Can Filler	马口铁桶灌装机 Smei-automatic Beer Can Filler
设备型号 (Model)	AFMKT3-1	AFMKT3-2
设备尺寸 (Size:W*L*H)	0.90*0.58*1.78M	0.75 × 0.5 × 1.78M
设备重量 (Weight)	106KGS	106KG
工作能力 (Capacity)	100-120pcs/Hr(5L)	100-120pcs/Hr
电源参数 (Power)	According to user local power(110-230V 50/60Hz Single Phase)	According to user local power (110-230V 50/60Hz Single Phase)
适用桶形 Keg type	适用于1L 2L 5L马口铁罐 1L 2L 5L Tinplate bottle	只适用于1L和2L马口铁罐 1Land2L Tinplate bottle

Can Filling System(Flash Boy) 易拉罐灌装机 (闪电男孩)



产品特点

- 能够灌装标准的所有罐型，随时切换
- 全自动吹扫、灌装、落盖和封边
- 简单操作，所有系统功能可通过时间调整
- 增加状态运行灯，时刻体现设备运行状态
- 完善的CIP系统便于清洗
- 6步绝氧，啤酒更好的保鲜

Product features

- Can fill all standard can types, switch at any time
- Automatic purging, filling, lid dropping and edge sealing
- Simple operation, all system functions can be adjusted by time
- Add the status running indicator to reflect the running status of the device at all times
- Perfect CIP system for easy cleaning
- 6 steps to eliminate oxygen, beer better preservation

设备名称 (Name)	易拉罐灌装机 Can filling system
设备型号 (Model)	FBCS1-1
设备尺寸 (Size:W*L*H)	1020*760*1780mm
设备重量 (Weight)	153kg
工作能力 (Capacity)	6-8pcs/min
电源参数 (Power)	Singel Phase 110V-240VAC 50/60Hz is default
适用桶形 Keg type	Flash Boy FBCS1-1 can be configured for nearly all standard can sizes

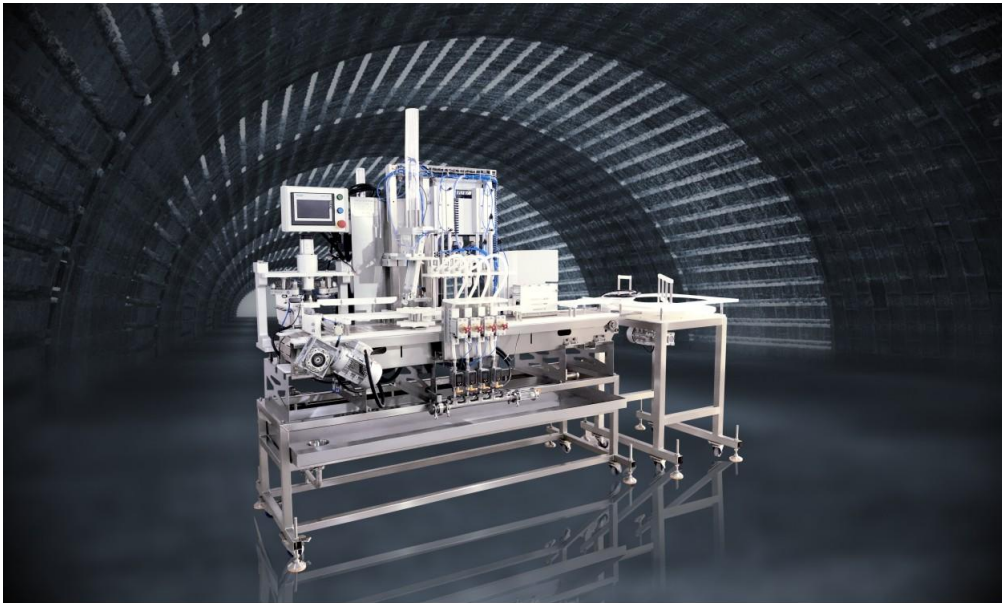

Can Filling System

易拉罐灌装机

设备名称 (Name)	易拉罐灌装封盖机 Can filling system
设备型号 (Model)	SDC4-4
设备尺寸 (Size:W*L*H)	2.00 × 0.91 × 1.85M
设备重量 (Weight)	337KG
工作能力 (Capacity)	1500-1800pcs/H(330ml) 495-594L/H 1200-1500pcs/H(500ml) 600-750L/H
电源参数 (Power)	According to user local power (3 Phases 380V 50Hz)
适用桶形 (Keg type)	300ml use in china in default (Sample offer by customer)

产品特点

- 四工位运行，高效灌装
- 能够灌装标准的所有罐型，随时切换
- 全自动吹扫、灌装、落盖和封边
- 简单操作，所有系统功能可通过时间调整
- 增加状态运行灯，时刻体现设备运行状态
- 完善的CIP系统便于清洗

Product features

- Four station operation, efficient filling
- Can fill all standard tank types, switch at any time
- Automatic purging, filling, lid dropping and edge sealing
- Simple operation, all system functions can be adjusted by time
- Add the status running indicator to reflect the running status of the device at all times
- Perfect CIP system for easy cleaning

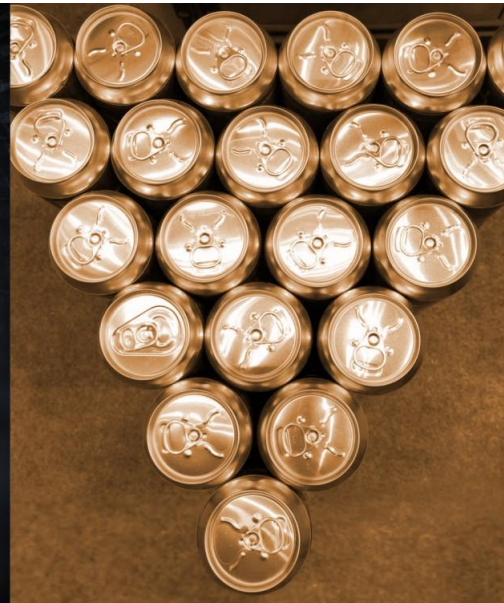

Can Filling System

易拉罐灌装机 (闪电男孩)

产品特点

- 辅助易拉罐灌装机进罐，省时省力
- 一键启动，提高效率

Product features

- Auxiliary can filling machine into the can, save time and effort
- One key start, improve efficiency

设备名称 (Name)	易拉罐理罐平台 (闪电男孩) Rotary infeed table(Flash boy)	易拉罐理罐平台 (四工位) Rotary infeed table(Four station)
设备型号 (Model)	RIT-60	RIT-80
设备尺寸 (Size:W*L*H)	0.6 × 0.6 × 0.98M	0.9 × 0.9 × 1.25M
设备重量 (Weight)	39KG	75KG

Talos Keg Filler 太空桶灌装机



产品特点

- 多种规格选配, 可供根据客户需求选择
- 西门子控制单元, 精准控制
- 材质为精选食品级304不锈钢, 经久耐用, 质量可靠
- 可灌装多种桶形规格, 独立控制, 灵活方便

Product features

- Various specifications are optional, available according to customer needs
- Siemens control unit, precise control
- Material for selected food grade 304 stainless steel, durable, reliable quality
- Can fill a variety of keg specifications, independent control, flexible and convenient



设备名称 (Name)	双工位太空桶灌装机 Double station keg filler	三工位太空桶灌装机 Three station keg filler
设备型号 (Model)	F2-11N-T-H-1M-L	F3-11N-T-H-1M-L
设备尺寸 (Size:W*L*H)	1.20X1.41X2.13M	1.77X1.28X2.13M
设备重量 (Weight)	298KG	375KG
工作能力 (Capacity)	50-60pcs/h	80-90pcs/h
电源参数 (Power)	According to user local power (3 Phases 380V 50Hz)	According to user local power (3 Phases 380V 50Hz)
适用桶形 Keg type	太空桶20L-30L keg	太空桶20L-30L keg

产品特点

- 塔罗斯3L-10L桶专用
- 材质为精选食品级304不锈钢, 经久耐用, 质量可靠
- 西门子控制单元, 精准控制

Product features

- Talos 3L-10L bucket dedicated
- Material for selected food grade 304 stainless steel, durable, reliable quality
- Siemens control unit, precise control

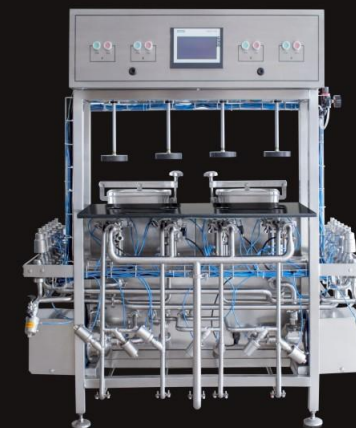

设备名称 (Name)	Talos灌装机 Four heads Talos keg filler
设备型号 (Model)	F2-22S-T-H-1M-KK
设备尺寸 (Size:W*L*H)	1.44X1.04X1.66M
设备重量 (Weight)	213KG
工作能力 (Capacity)	3L talos 1工位/H: 30-50桶 10L talos 1工位/H: 20-25桶
电源参数 (Power)	According to user local power (3 Phases 380V 50Hz)
适用桶形 Keg type	Talos 3L-10L 桶

设备名称 (Name)	Talos灌装机 Four heads Talos keg filler
设备型号 (Model)	F4-22S-T-H-1M-KK
设备尺寸 (Size:W*L*H)	1.44X1.04X1.66M
设备重量 (Weight)	213KG
工作能力 (Capacity)	3L talos 1工位/H: 30-50桶 10L talos 1工位/H: 20-25桶
电源参数 (Power)	According to user local power (3 Phases 380V 50Hz)
适用桶形 Keg type	Talos 3L-10L 桶



BEER KEG WASHER AND FILLER

清洗灌装一体机

产品特点

- 一机两用，集清洗灌装于一体
- 根据客户需求选配工位水箱水泵及加热方式
- 中英文界面PLC采用德国西门子，精准控制
- 可编程控制器全过程自动控制，参数通过触摸屏调整
- 技术成熟，清洗灌装稳定可靠

Product features

- One machine and two use, set cleaning and filling in one
- According to customer demand, the station water tank, water pump and heating mode are optional
- English and Chinese interface PLC adopts German Siemens, precise control
- Programmable controller automatic control of the whole process, parameters through the touch screen adjustment
- Mature technology, washing and filling stable and reliable.



Beer Keg Washer And Filler 清洗灌装一体机

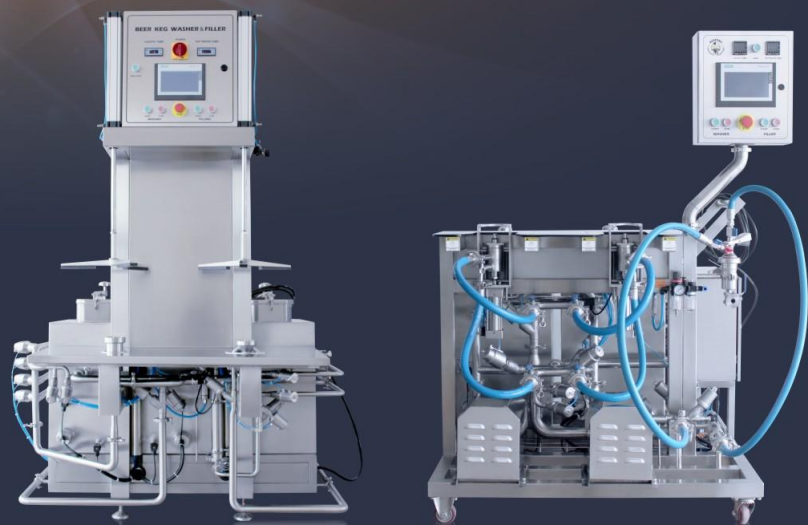

设备名称 (Name)	三工位啤酒桶清洗 灌装一体机	双工位啤酒桶清洗 灌装一体机	双工位啤酒桶清洗 灌装一体机
设备型号 (Model)	CFA3-22E(S)-T-S-1-2N	CFA2-22S(E)-T-H-1-1N	CFA2-33E(S)-T-H-1-1N
设备尺寸 (Size:W*L*H)	1.25X1.40X1.59M	1.50X1.51X2.15M	1.60X1.60X2.15M
设备重量 (Weight)	223KG	246KG	286KG
工作能力 (Capacity)	Wahing part:40-50pcs/h Filling part:40-50pcs/h	Wahing part:15-20pcs/h Filling part:40-50pcs/h	Wahing part:15-20pcs/h Filling part:40-50pcs/h
电源参数 (Power)	According to user local power (3 Phases 380V 50Hz)	According to user local power (3 Phases 380V 50Hz)	According to user local power (3 Phases 380V 50Hz)
适用桶形 Keg type	欧标 德标 美标 EURO DIN AMERICAN 20L-60Lkeg	欧标 德标 美标 EURO DIN AMERICAN 20L-60Lkeg	欧标 德标 美标 EURO DIN AMERICAN 20L-60Lkeg

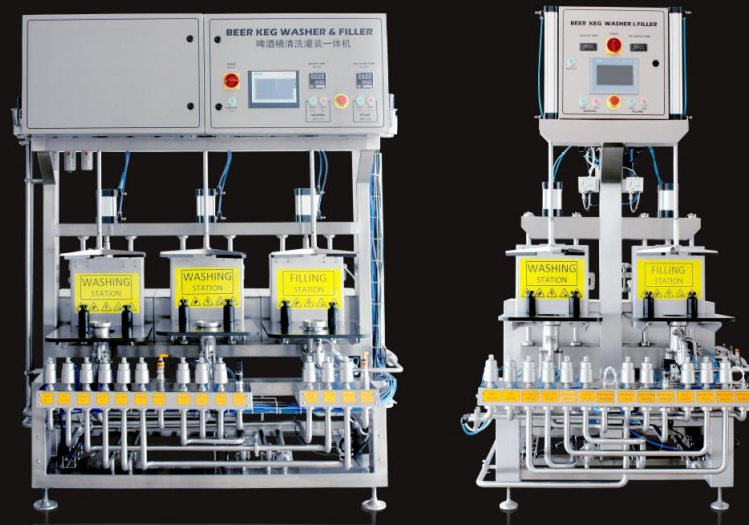

设备名称 (Name)	双工位啤酒桶清洗 灌装一体机 (活动台面)	三工位啤酒桶清洗 灌装一体机 (活动台面)	四工位啤酒桶清洗 灌装一体机 (活动台面)
设备型号 (Model)	CFA2-22S-T-H-1-1M-L	CFA3-33S(E)-T-H-1-1M-L	CFA4-33S(E)-T-H-1-1M-L
设备尺寸 (Size:W*L*H)	1.15X1.51X2.15M	1.80X2.30X2.08M	1.80X2.30X2.08M
设备重量 (Weight)	338KG	680KG	720KG
工作能力 (Capacity)	Wahing part:20-30pcs/h Filling part:40-60pcs/h	Wahing part:40-50pcs/h Filling part:40-50pcs/h	Wahing part:60-90pcs/h Filling part:40-50pcs/h
电源参数 (Power)	According to user local power (3 Phases 380V 50Hz)	According to user local power (3 Phases 380V 50Hz)	According to user local power (3 Phases 380V 50Hz)
适用桶形 Keg type	欧标 德标 美标 EURO DIN AMERICAN 20L-60Lkeg	欧标 德标 美标 EURO DIN AMERICAN 20L-60Lkeg	欧标 德标 美标 EURO DIN AMERICAN 20L-60Lkeg

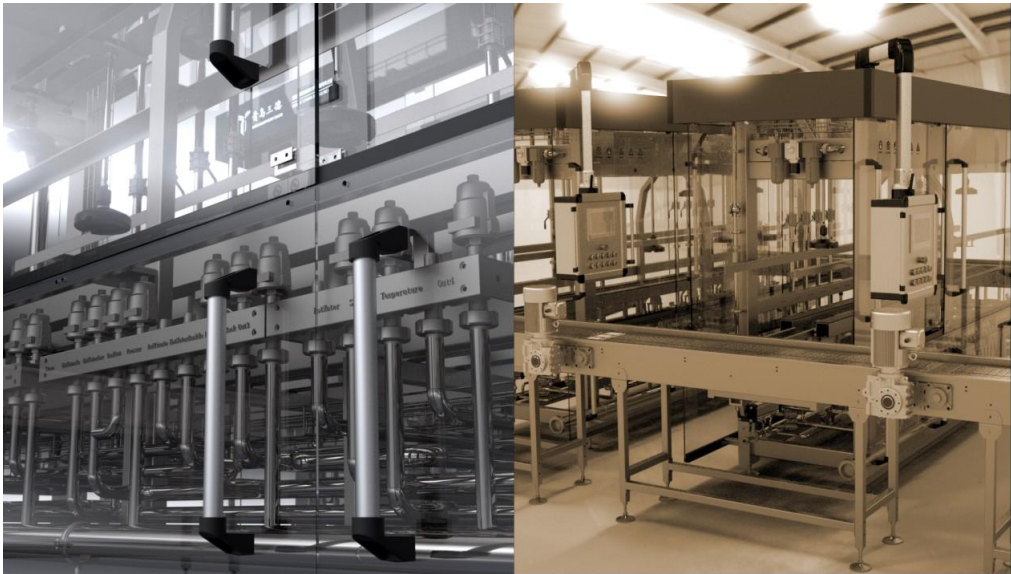

KEG WASHING AND FILLING SYSTEM

清洗灌装线

配置方案 Configuration scheme

设备框架、管路、阀门、水箱等均采用标准AISI304材质；电器部件、水泵、检测元件、传感器等均采用高档配置。

The frame, pipeline, valve, water tank are made of standard AISI304 material; electrical components, water pumps, testing components, and sensors are made of high-grade configuration.

基本布局 Basic layout

根据公司提供的实际场地实际动线，尽可能对有限场地实现最佳的利用率，我们建议“桶装线”采用大U字摆放结构，这样可以有效利用现场空间，达到85%的场地利用率，便于操作的同时，给空桶和成品桶留出了较大的储存空间。

According to the actual site provided by the company, as far as possible to achieve the best utilization rate, we suggest that "Beer Keg line" using big U word put structure, which can effectively use the site space, 85% site utilization rate, easy to operate at the same time, to empty bucket and finished barrel left a larger storage space.



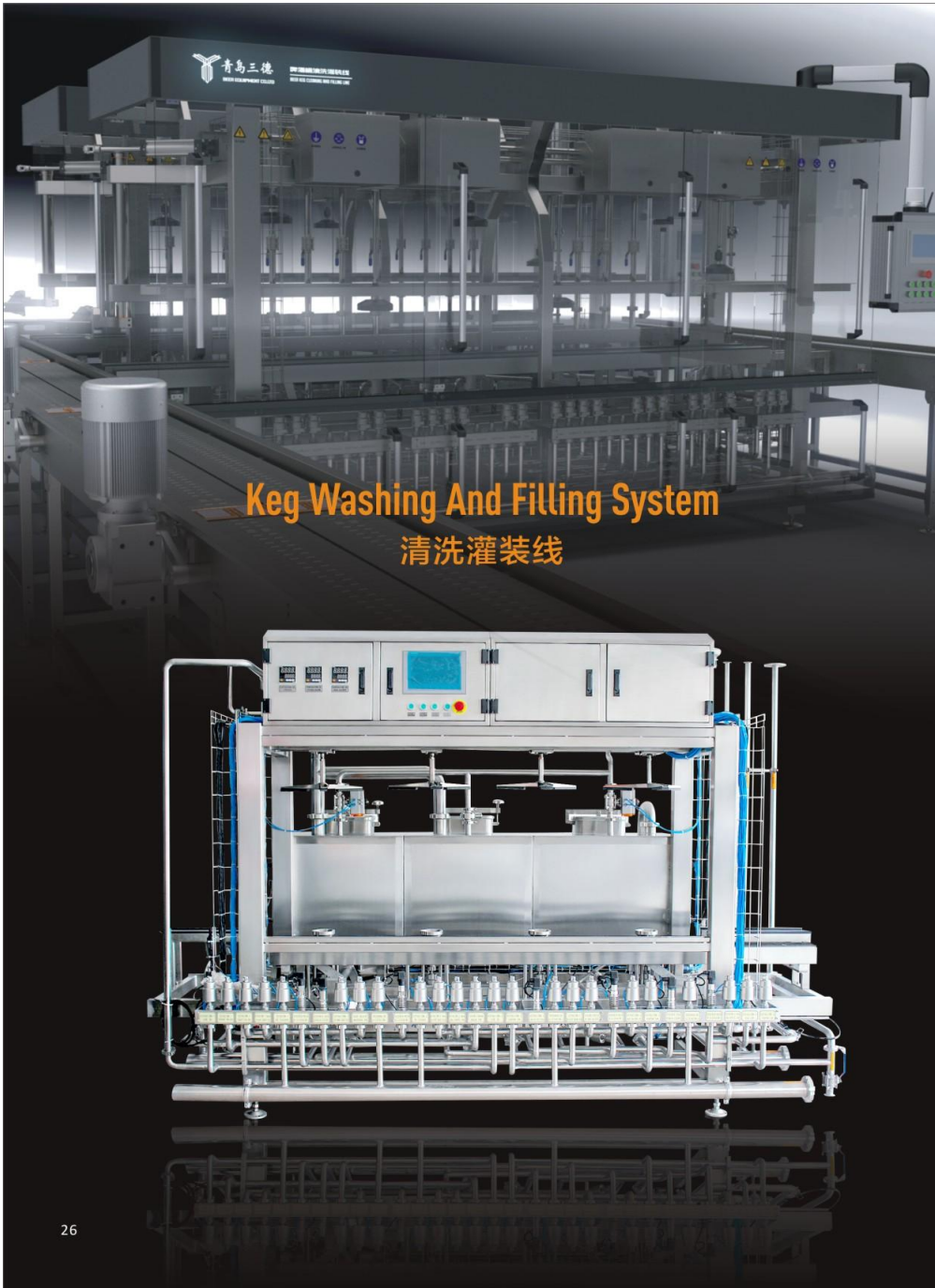

Keg Washing And Filling System
清洗灌装线

桶装扎啤酒自动清洗灌装线外部条件

桶装扎啤酒自动清洗灌装线生产的桶装扎啤酒是具有类似纯生啤酒相近的卫生指标。要想生产出合格的扎啤酒，需要关注以下的环节：

- 1. CO₂: 无菌的CO₂是在生产中为缓冲罐备压，为灌装线吹扫酒桶中的残余蒸汽和备压的必须。因为直接与酒接触，其卫生指标好坏直接关系到产品的卫生指标和保质期。压力3KG，流量3M³/h。必须保证无菌。
 - 2. 压缩空气：生产设备需要清洁干燥、无杂质的压缩空气，否则将影响气动件的使用寿命。压力6-8KG，流量5 M³/h，干燥无水。
 - 3. 蒸汽：压力5KG，流量5 M³/h。
 - 4. 酒精水：压力2 KG，流量8 T/h，温度-2到-5度。
 - 5. 软化水：灌装线对扎啤酒桶的刷洗，必须使用软化水，否则将影响产品的质量，并影响设备的正常运转，减少设备的使用寿命。压力3 KG，流量5 M³/h。
 - 6. CIP：需使用85度热碱水、流量4T/h循环30分钟和85度的热水，流量4T/h。不回收大于等于30分钟
 - 7. 啤酒：压力2 KG，流量2T/h。
 - 8. 维护卫生用自来水：压力2-3 KG。
- 以上要点，请务必严格执行。否则因外部条件不善，不仅影响成品质量，还可能损毁设备。在使用过程中更要对设备加强保养！



Automatic clean the external conditions of the filling line with bottled beer

Automatic cleaning and filling line production of keg beer is similar to pure raw beer. To produce a qualified fresh beer, we need to pay attention to the following links:

- 1. CO₂: sterile CO₂ is necessary to prepare pressure for the buffer tank in the production, and to sweep away the residual steam and prepare pressure in the beer keg of the filling line. Because of the direct contact with the beer, the health indicators are directly related to the health indicators and shelf life of the product. Pressure 3KG, flow rate 3 M³/h.. must be guaranteed sterile.
- 2. Compressed air: production equipment needs clean, dry, free compressed air of impurities, otherwise it will affect the service life of pneumatic parts. Pressure of 6-8KG, flow rate of 5 M³/h, dry without water.
- 3. Steam: pressure of 5KG, flow rate of 5 M³/h.
- 4. Alcohol water: pressure 2KG, flow rate 8T/h, temperature-2 to-5 degrees.
- 5. Softening water: the filling line must be used to wash the keg, otherwise it will affect the quality of the beer, affect the normal operation of the equipment, and will reduce the service life of the equipment. Pressure: 3KG, flow rate: 5 M³/h.
- 6. CIP: Hot water of 85 degrees, 4T/h, 30 minutes and 85 degrees, and 4T/h. No recovery is more than or equal to 30 minutes
- 7. Beer: pressure 2KG, flow rate 2T/h.
- 8. Tap water for sanitary maintenance: pressure 2-3KG.

Please strictly implement the above key points. Otherwise, due to poor external conditions, not only affect the quality of the finished products, but also may damage the equipment. In the process of use, it is more necessary to strengthen the maintenance of the equipment!

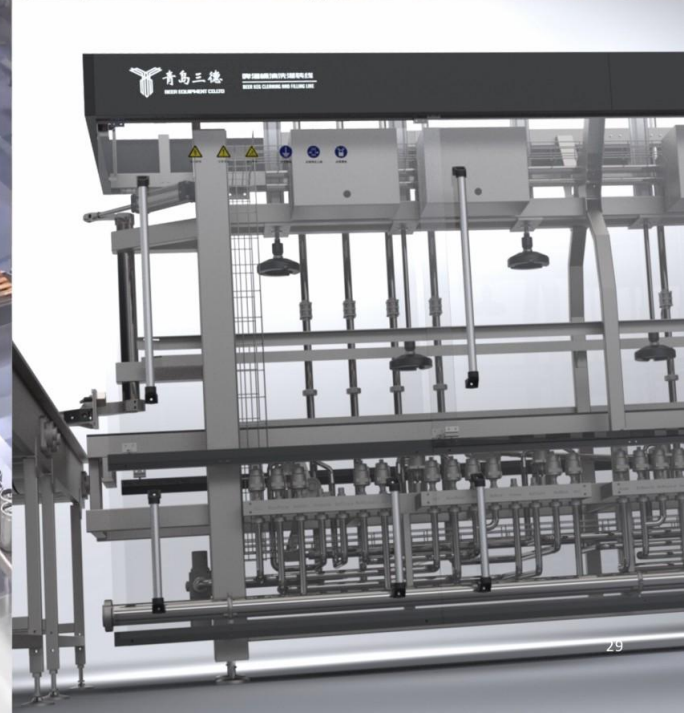
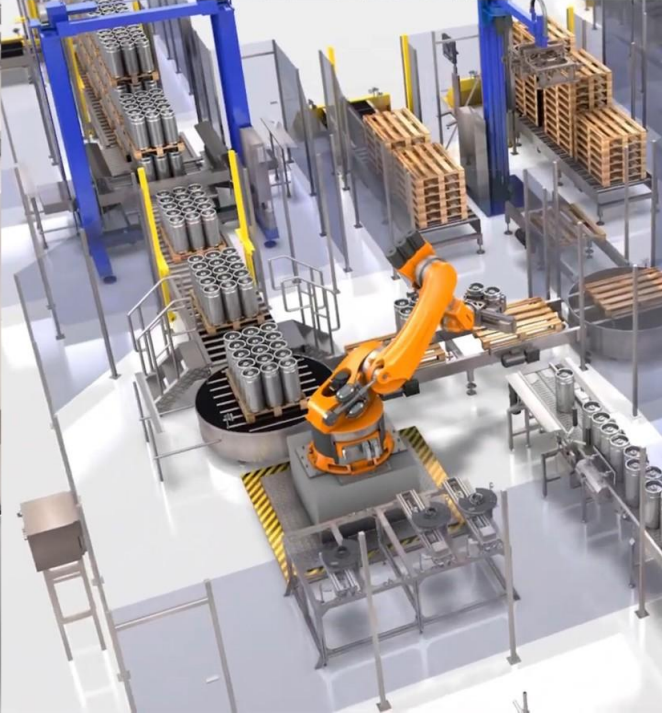
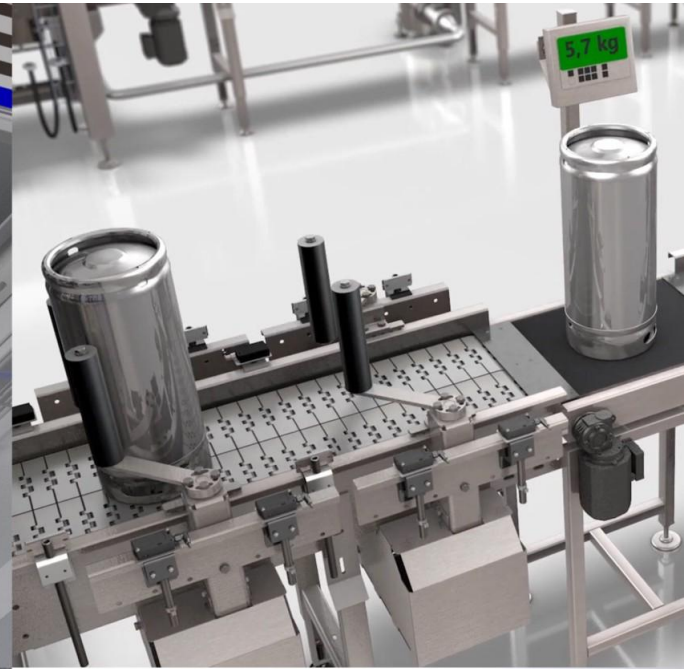
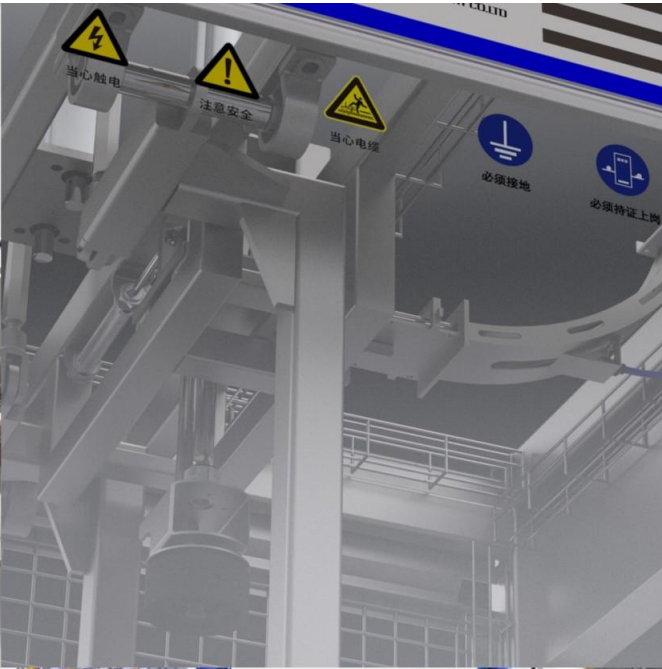
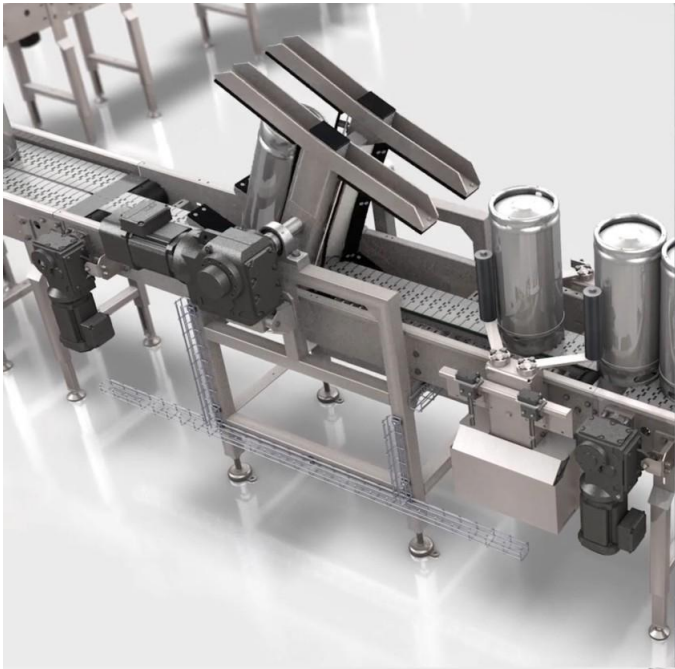

PASTEURIZER

巴氏瞬时杀菌机

产品介绍

SDSS系列巴氏瞬时杀菌机，泵体均为不锈钢制作，经久耐用，适合啤酒行业使用；采用三段换热组合结构，达到啤酒保鲜，保质，是无菌灌装的必备部分。

Product introduction

SDSS series pasteurized instantaneous sterilization machine, the pumps are stainless steel, durable, suitable for the beer industry; using three-stage heat exchange combination structure, to achieve beer preservation, quality, is a necessary part of aseptic filling.





Pasteurizer 巴氏瞬时杀菌机

工作原理

准备杀菌的啤酒经过高压啤酒泵进入板式换热器，预加热到65℃，再被85℃的热水加热到75℃，在保温管段保温30秒后达到巴氏杀菌单位25Pu值，后通过板式换热器降温至12℃，最后进入冷却系统冷却至2℃，随后进入缓冲罐进行后续灌装。

操作时杀菌温度低于工艺要求(设定为75℃)时，可自动进入循环状态，当杀菌温度升到75℃时延时1分钟自动关闭循环阀，开启出酒气动蝶阀，保证杀菌质量。其它控制参数超出设定值时，设备报警并自动停车。

Introduce

The beer ready to sterilize passes through the high-pressure beer pump into the plate heat exchanger, Pre-heated up to 65℃, Again heated by 85℃ of hot water to 75℃, After being section for 30 seconds, It can reach a pasteurized unit value of 25Pu. Then cool down to 12℃ through the plate heat exchanger, Finally, enter the cooling system and cool down to 2℃, Then enter the buffer tank for subsequent filling.

When the sterilization temperature is below the process requirements (set to 75℃), it can enter the cycle state automatically, When the sterilization temperature rises to 75℃, Automatic shut the circulation valve for 1 minute. Open the wine pneumatic butterfly valve, Ensure the quality of sterilization. When the other control parameters exceed the set value, the equipment alarms and stops automatically.

产品特点

- 三段式换热组合结构，换热效果好，节省能源
- 瞬时杀菌，确保啤酒的风味、营养，最小程度的丢失
- 阀门、管路、泵体，均采用食品级不锈钢制作，确保啤酒卫生安全
- 流量计，气动阀均采用进口品牌，搭配西门子显示屏，可对每个环节进行高度监控
- 采用PID闭环调节方式，配合CI系统，对设备进行全自动清洁
- 结构倾向低、体积小、热损小、维护价格低，性价比极高

Feature

- Three-stage heat exchange combination structure, good heat exchange effect, and energy saving
- Instantaneous sterilization, to ensure that the beer flavor, nutrition, the minimum degree of loss
- Valves, pipes and pump body are made of food-grade stainless steel to ensure beer hygiene and safety
- Flow meter, pneumatic valve are imported brand, with Siemens display, can each link to be highly monitored
- Using PID closed-loop adjustment mode, cooperate with CI system, fully automatic cleaning of the equipment
- Low structural tendency, small volume, small heat loss, low maintenance price, very high sex price

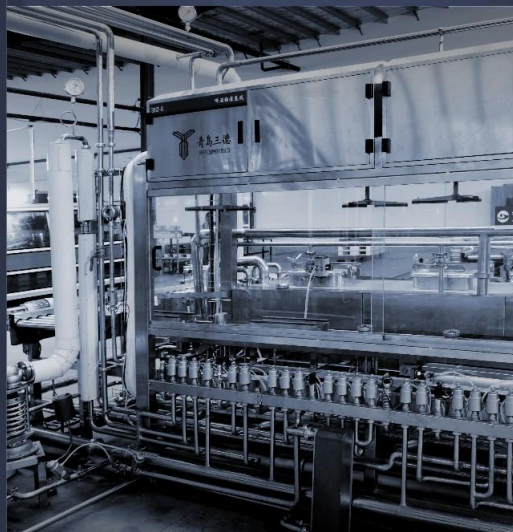

- 加热形式：蒸汽加热；
- 制冷剂温度：-5℃~-2℃；
- 制冷剂压力：0.1~0.3Mpa；
- 冷水压力：0.2~0.3Mpa；
- 蒸汽压力：0.2~0.5Mpa；
- 电压：380v 3phase 50Hz

- Heating form: steam heating;
- Refrigerant temperature: -5℃~-2℃ ;
- Refrigerant pressure: 0.1~0.3Mpa;
- Cold water pressure: 0.2~0.3Mpa;
- Steam pressure: 0.2~0.5Mpa;
- Power: 380v 3phase 50Hz

型号规格 (Model)	生产能力 (L/H)	制冷剂用量 (m ³ /H)	蒸汽用量 (KGs/H)	功率 (Kw)	尺寸 (m)
SDSS-500	500	1	20	2.0	1.40×1.40×1.80
SDSS-1000	1000	2	30	2.0	1.40×1.40×1.80
SDSS-2000	2000	4	50	2.5	1.50×1.60×2.00
SDSS-3000	3000	6	70	3.0	1.50×1.60×2.00
SDSS-4000	4000	8	90	3.5	1.60×1.80×2.20
SDSS-5000	5000	10	110	4.0	1.60×1.80×2.20
SDSS-6000	6000	12	130	5.0	1.80×2.00×2.20
SDSS-7000	7000	14	150	6.0	1.80×2.00×2.20
SDSS-8000	8000	16	170	7.0	1.80×2.20×2.20
SDSS-10k	10k	20	210	7.5	1.80×2.20×2.20

CORKING AND WIRE CAGING MACHINE

打塞扎丝机

产品特点

- 捆丝部分由特殊材料制成，非常坚硬。
- 智能控制组合，智能检测，如果工位没有瓶子，橡木塞及丝笼不会掉落，减少浪费
- 可适应不同高度的瓶子，只需要简单的调整机器配件。
- 运行异常，设备会自动检测停止工作，确保生产安全性

Product features

- The baling wire part is made of special material and is very hard.
- Intelligent control combination, intelligent detection, if there is no bottle at the station, oak plug and silk cage will not fall, reduce waste
- Can adapt to different heights of bottles, only need a simple adjustment of machine accessories.
- If the operation is abnormal, the equipment will automatically detect and stop working to ensure the safety of production.



Corking And Wire Caging Machine

打塞扎丝机



设备名称(Name)	半自动打塞扎丝一体机 Semi-auto corking and wire caging machine	全自动打塞扎丝一体机 Auto-Corking and wire caging machine
设备型号(Model)	SDPKG-1	SDPKG-2
设备尺寸 (Size:W*L*H)	1020*720*1800 mm	1300*1180*2200 mm
设备重量(Weight)	248kg	2000 kg
工作能力(Capacity)	200~300pcs/h	1800~2000pcs/h
电源参数(Power)	220 50hz 1 phase	380v 3phase 50hz
总功耗 (Power consumption)	100w	2.0kw
耗气量Air (consumption)	100L/min	0.5Mpa;10L/min
打塞工位 (Corking station)	1	1
捆丝工位 (Wire caging station)	1	1
设备材质(Main Material)	SUS304	SUS304
瓶直径范围 (Bottle diameter range)	D80-125mm	D70-155mm
瓶高范围(Bottle height range)	H230-320mm	H220-390mm

Manual cleaning of filling and plugging wire in one machine

手动清洗灌装打塞扎丝一体机



设备尺寸 (Size: W*L*H)	1420*730*1830 mm
设备重量 (Weight)	350kg
工作能力 (Capacity)	打塞 200~300pcs/h 灌装: 90~100pcs/h
电源参数 (Power)	220v 50hz 1 phase
总功耗 (Power consumption)	100w
耗气量 (Air consumption)	100L/min
气源压力 (Air pressure)	0.7mpa
清洗压力 (Washing pressure)	0.1~0.15mpa
打塞工位 (Corking station)	1
捆丝工位 (Wire caging station)	1
清洗工位 (Washing station)	2
灌装工位 (Filling station)	2
设备材质 (Main Material)	SUS304
瓶直径范围 (Bottle diameter range)	D80-125mm
瓶高范围 (Bottle height range)	H230-320mm